



Liberty II Wheelchair



Assembly Quick Guide

IMPORTANT: Before starting to assemble the wheelchair, please pay special attention to the different screw, bolt, nut, and washer sizes. Each screw and bolt size has a specific place in the assembly. Please pay attention to the instructions on where to install each size.



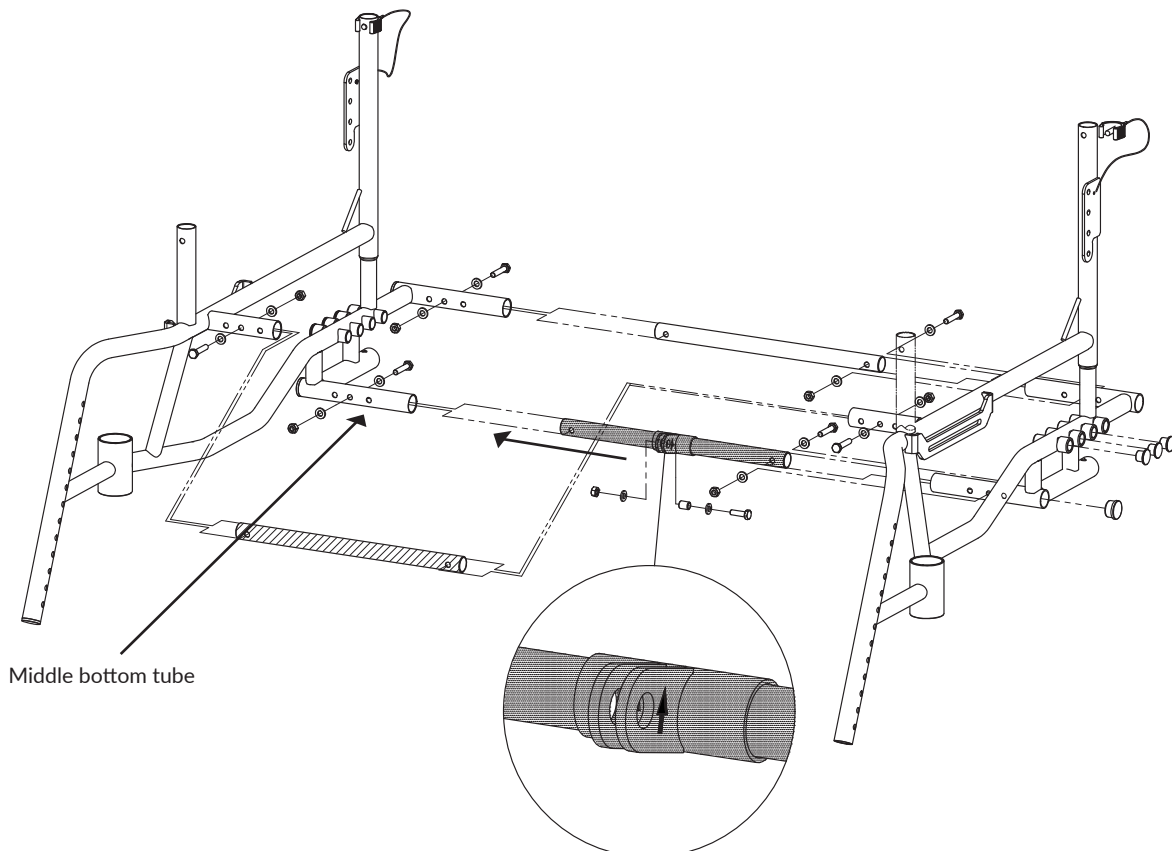

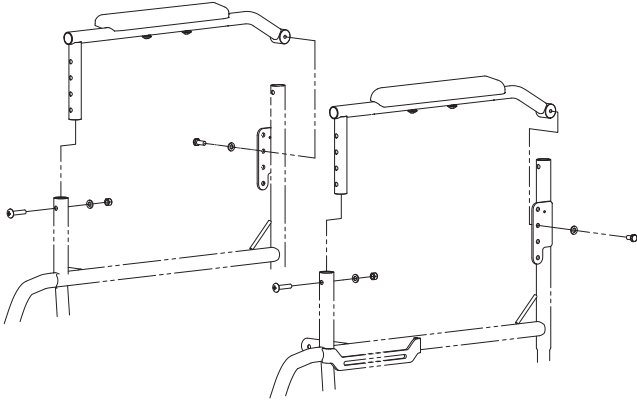

Quick Frame Assembly Guide

Step 1: Assemble the right and left frame tubes. Use six M6 hex head cap screws 30-mm long , twelve M6 washers  and six M6 nylon lock nuts . The tilt-in-space mechanism should be attached in lower middle tube position and with the **arrow pointing upward** as shown in the circle.



Step 2: Assemble the armrests. Use two M6 hex head cap screws 30-mm long , two M6 washers and two M6 nylon lock nuts in the front; two M6 Philips pan head screws 10-mm long  and two M6 washers in the back.



Step 3: Assemble the front casters and push handle. Push handle: Use two button clips  and two pin clips . Front casters: Make sure there are two bearings  in each of the caster tubes. Use two M12 nuts  and two M12 washers . Cover the caster axle tube with two 38-mm plastic caps .

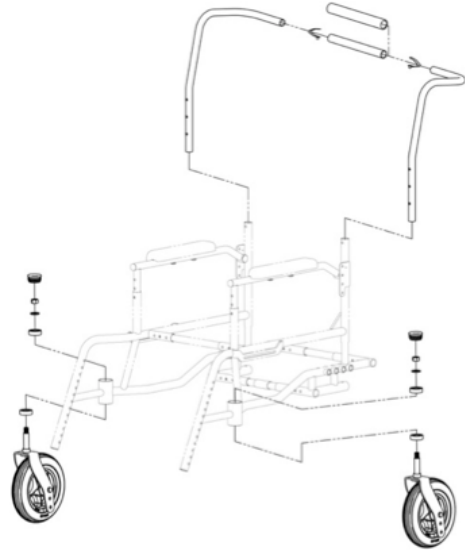

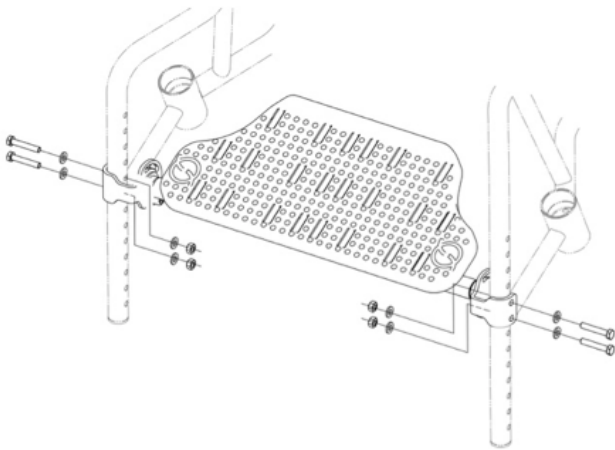

Step 4: Assemble the footrest. Use four M6 hex head cap screws 35-mm long , eight M6 washers and four M6 nylon lock nuts.



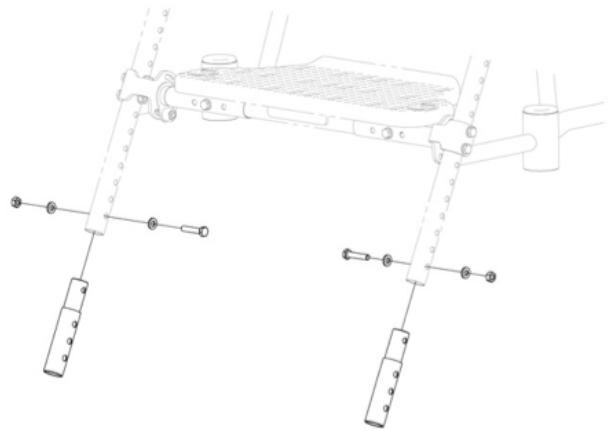

Step 5 (optional): Assemble the footrest tube extensions. Use two M6 hex head cap screws 30-mm long, four M6 washers, and two M6 nylon lock nuts.

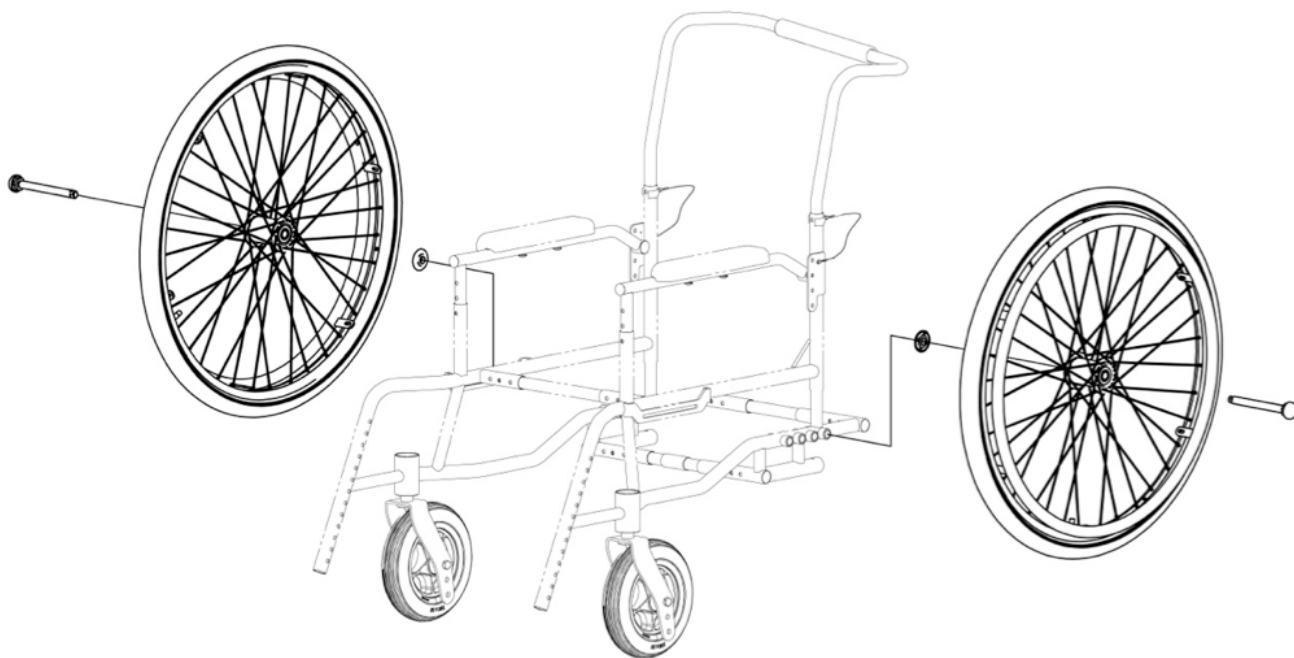

Step 6: Attach the rear wheels. Use two quick-release rear wheel axle pins  and two bearing covers .



Step 7: Assemble the wheel-locks. Use two M6 special screws 16-mm long , two M6 washers, and two M6 U-nuts with cap .

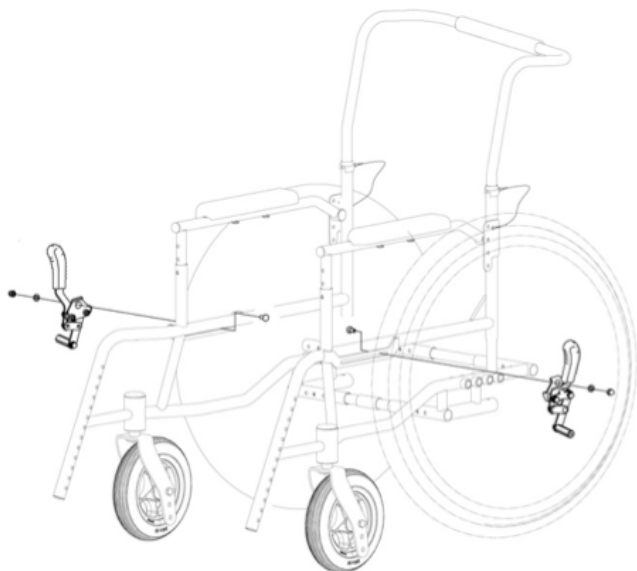

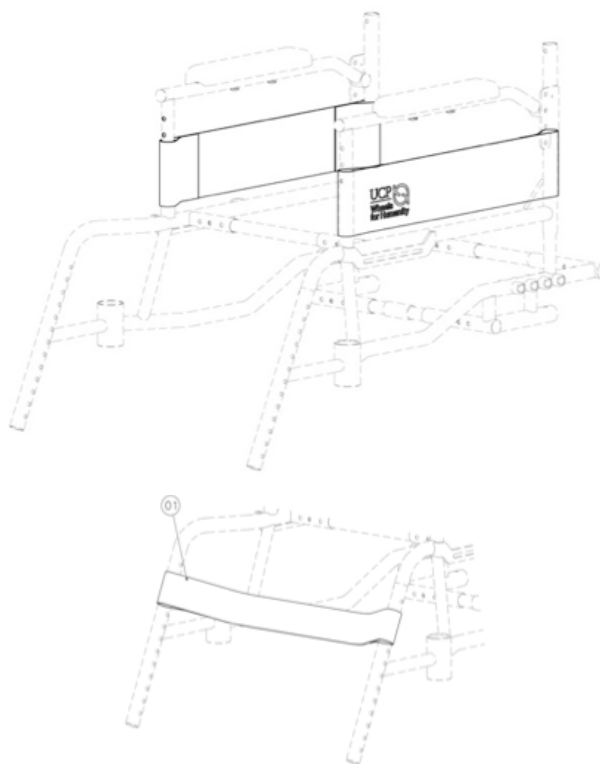

Step 8: Attach the side guards and the leg strap.



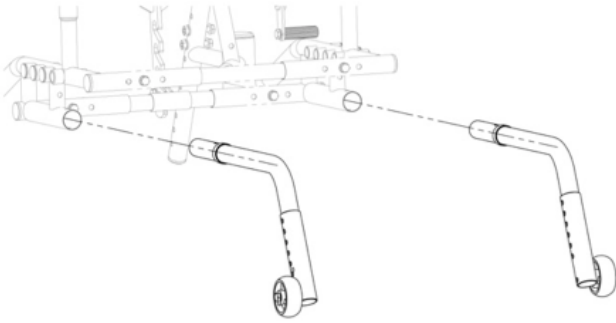

Step 9 (Optional): Assemble the anti-tippers.

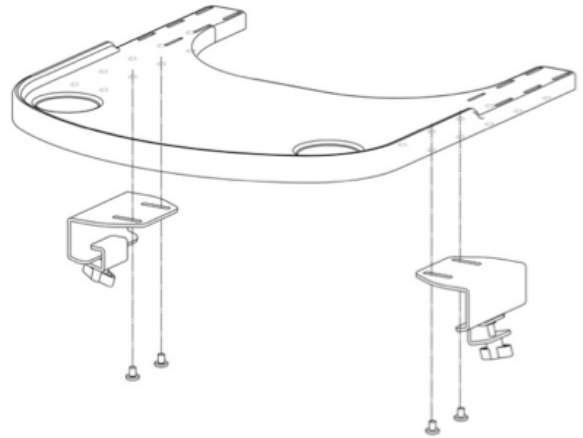

Step 10: Assemble the tray. Use four M6 Philips head pan screws 10-mm long  and two M6 knobs .







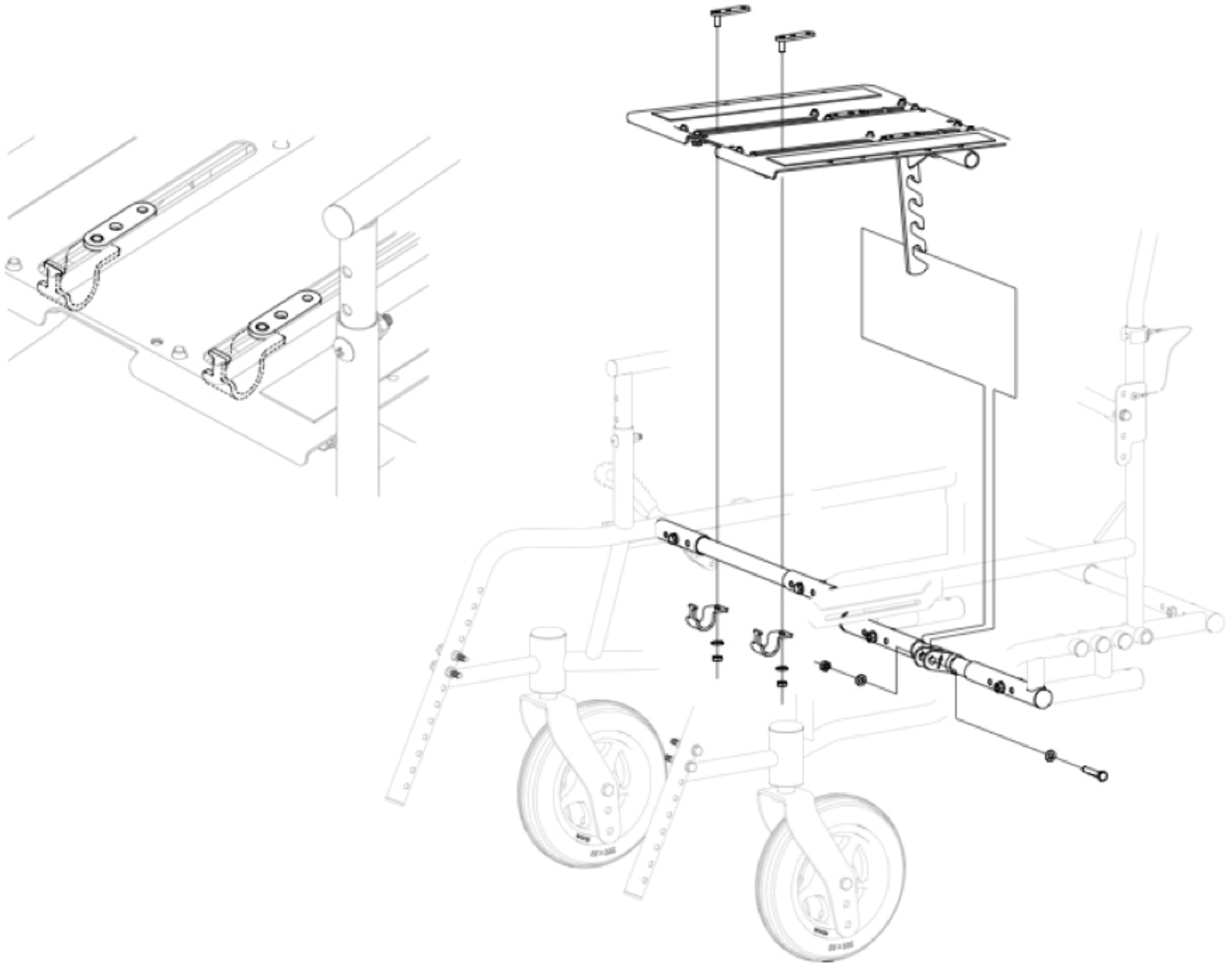

Quick Seat Unit Assembly Guide

Step 1: Attach the seat pan and the tilt mechanism to the frame. Seat pan front: Use two seat pan clamps , two bolts for seat pan clamps , two M6 washers, and two M6 nylon lock nuts. Hook the tilt mechanism of the seat pan on the anchor bolt of the frame.





Step 2: Attach the backrest pan to the seat pan and the back-frame posts.



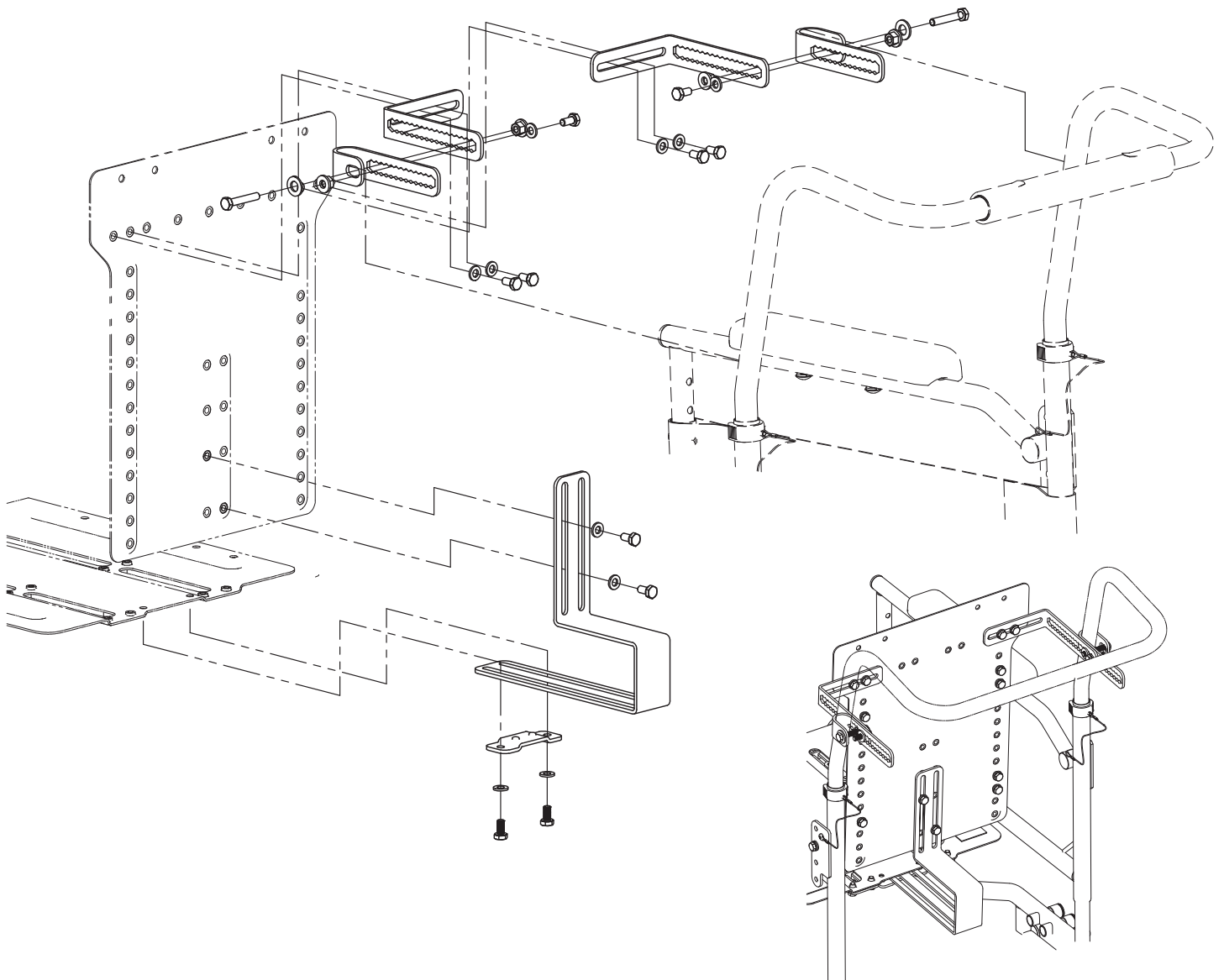

Seat pan to backrest pan: Use an attachment bracket  four M6 hex head cap screws 10-mm long , and four M6 washers .

Backrest pan to back-frame posts: Use four M6 hex head cap screws 10-mm long and four M6 washers to attach the “L” brackets to the backrest pan. Use two M6 hex head cap screws 10-mm long, two M6 washers, and two M6 nuts with flange  to attach the “L” brackets to the “U” brackets. Use two M6 hex head cap screws 35-mm long , two M8 washers , and two M6 nuts with flange to attach the “U” brackets to the back-frame posts.

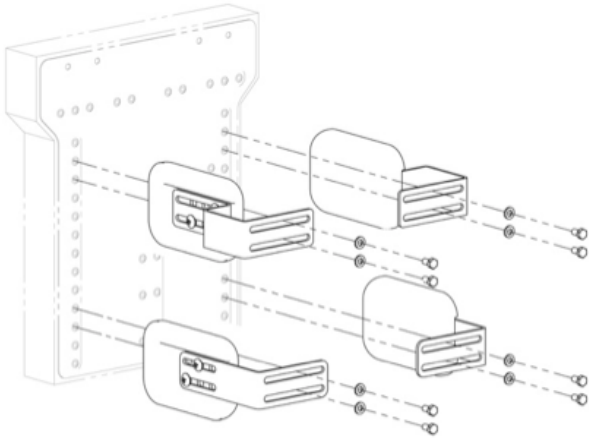

Step 3: Attach backrest cushion and the lateral supports (4) to the backrest pan. Use eight M6 Philips head pan screws 10-mm long  to attach the pads to the lateral support attachments. Use eight M6 hex head cap screws 10-mm long  and eight M6 washers  to attach the lateral support attachments to the backrest pan.



Step 4: Attach the headrest to the backrest pan. Use three M6 hex head cap screws 30-mm long  and three M6 washers  to attach the ball mounting bracket to the ball mounting tube. Use two M6 hex head caps screws 10-mm long  and two M6 washers to attach the headrest attachment mount to the backrest pan. Use two M6 knobs  to secure the horizontal and vertical headrest tubes. Insert a square plastic cap  into the squared end of the ball mounting tube.

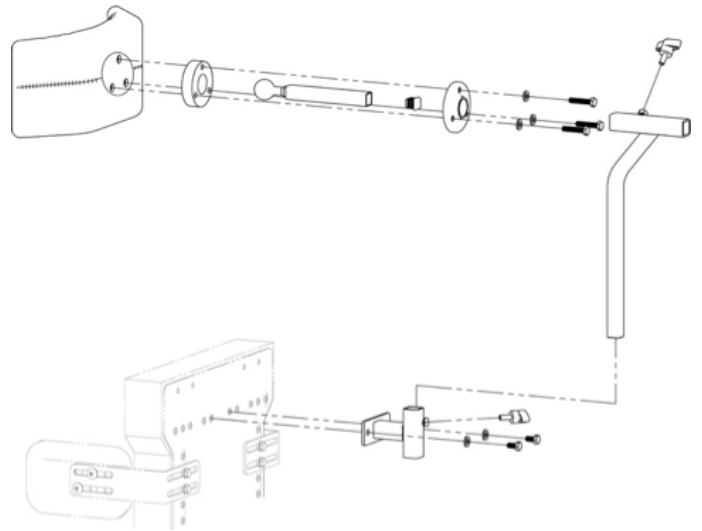



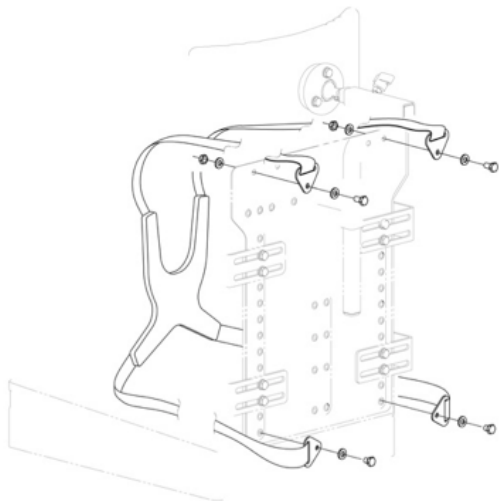

Step 5: Attach the chest harness to the backrest pan. Use four M6 hex head cap screws 10-mm long, eight M6 washers, and four M6 nylon lock nuts.

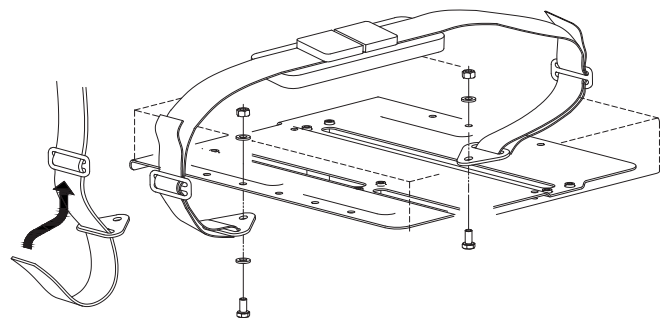

Step 6: Attach the pelvic strap to the seat pan. Use two M6 hex head cap screws 10-mm long, four M6 washers, and two M6 nylon lock nuts. Attach the seat cushion.



Step 7 (optional): Attach the abductor. Use two M6 Philips head pan screws 10-mm long  to attach the abductor pad to the bracket. Use an attachment bracket  , two M6 knobs  (or two M6 hex head cap screws 10-mm long ), and two M6 washers .

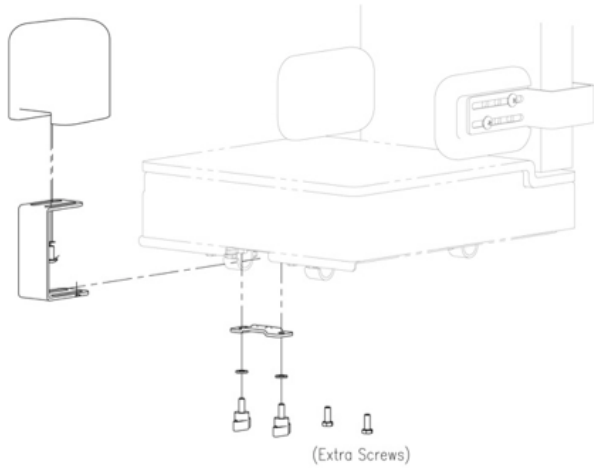

To adjust the pre-seat bone shelf:

1. Adjust the seat depth according to the user's needs.
2. Measure the distance from the back of the pelvis to the seat bones in mm.
3. $X = \text{distance from backrest to pre-seat bone shelf} = \text{distance from the back of the pelvis to the seat bones in mm} + 20\text{-}40 \text{ mm}$.
4. Adjust the pre-seat bone shelf length by cutting the excess foam.

