

# KDB-697B Instruction

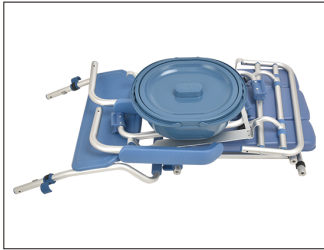

1. Frame\*2, crossing bar\*2, backrest\*1, armrest\*2, pedal\*1, bracket for bucket\*1, blue seat\*1

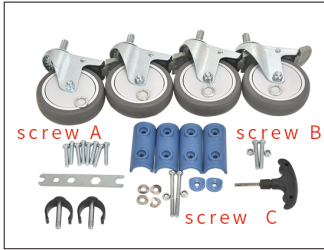

2. wheel\*4, blue plastic cover\*4, screw A\*8, screw B\*2, screw\*2, nut\*4, metal ring\*4, circle washer\*4, blue washer\*2, hexagonal screwdriver\*1, wrench\*1, C shape button\*2

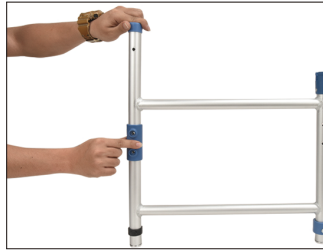

3. Install one side frame with a blue plastic cover



4. Install a crossing bar into the side frames, tightening it with hexagonal screwdriver

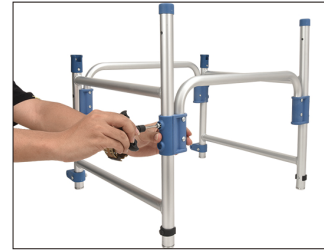

5. Fix plastic parts of both frames, tightening them with hexagonal screwdriver and screw A



6. Install backrest to frame



7. Insert armrests, lock screw C with circle washer



8. Put screw C inside the blue washer when installing armrest

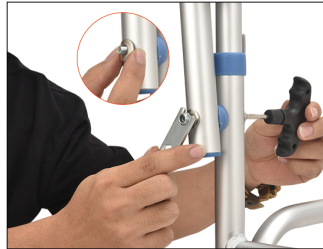

9. Cover circle washer and nut into screw C, tightening it with screwdriver



10. Put armrest into blue plastic part of back, with groove of front, with metal pin pops out



11. After armrest installed, insert armrest into groove of backrest, then insert C shape button



12. Armrests are installed



13. Install backrest to frame



14. Install screw B and nut, tightening with screwdriver and wrench



15. Turn over the frame to install wheels. Please must insert the metal rings



16. Please lock wheels before installing them



17. Wheels and pedal are installed



18. Put bracket of bucket on crossing bars



19. Put bucket on bracket of bucket, 20. installation is finished



21. Please press button before flipping armrest



22. Armrest flipping like this