

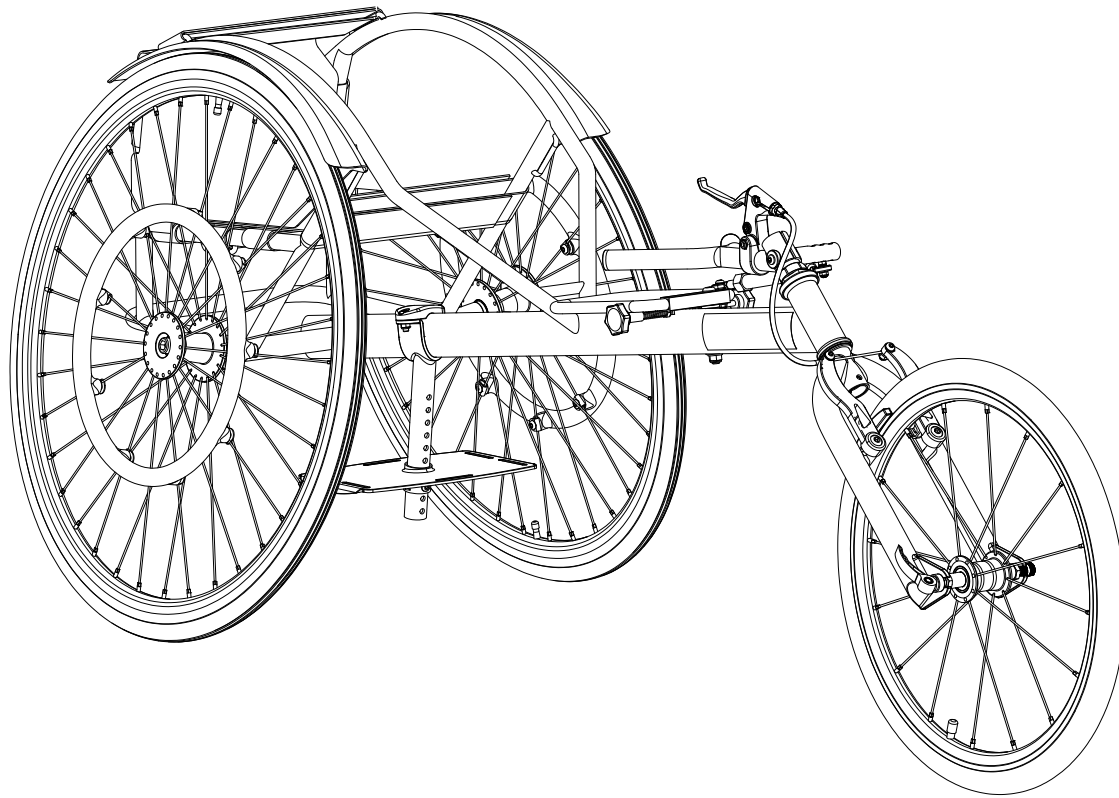

**motivation**  
FREEDOM THROUGH MOBILITY

## 'Flying Start' Racing Wheelchair

### Assembly Manual



August 2013

# Rear Wheel Assembly

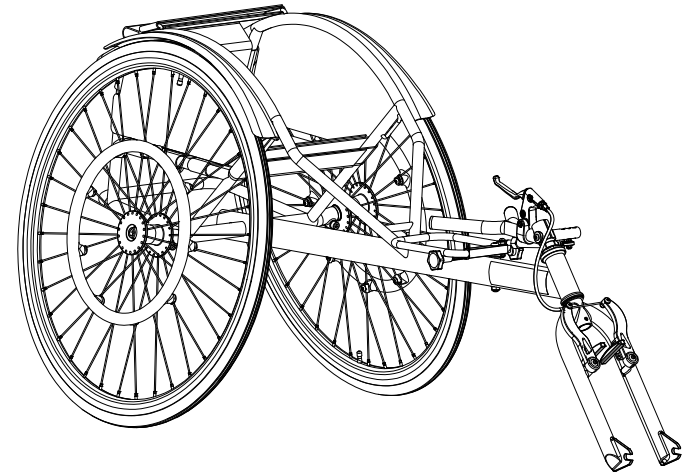
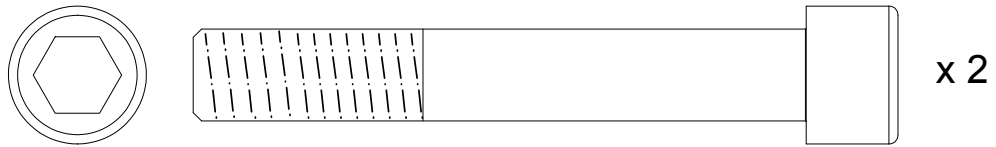

1 Slide the wheel into position, making sure the tyre is under the mud guard

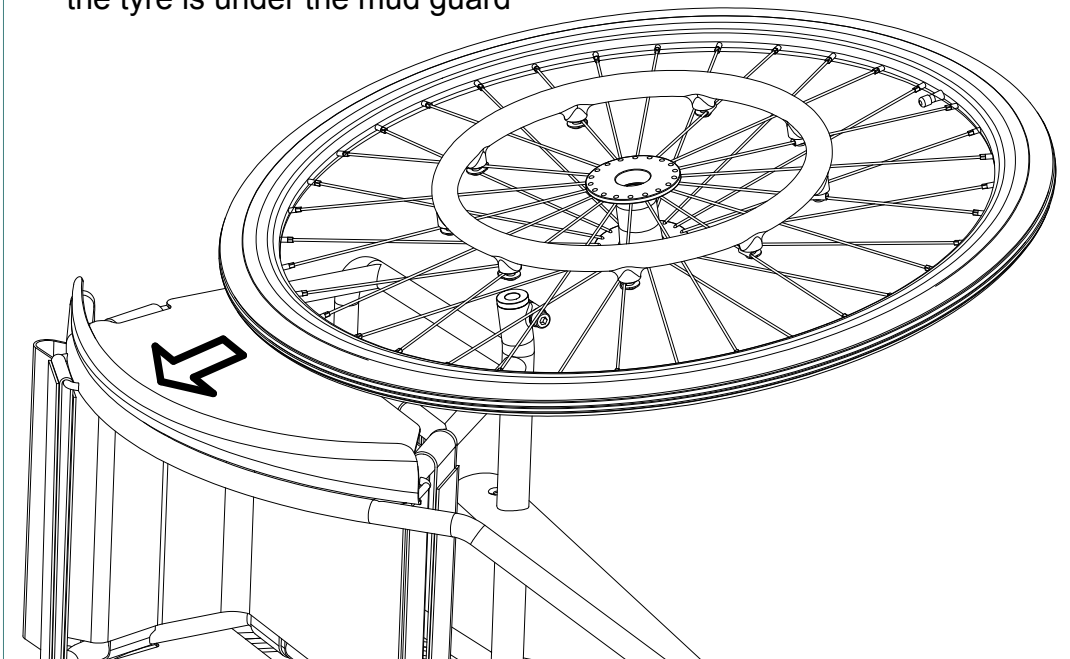

2

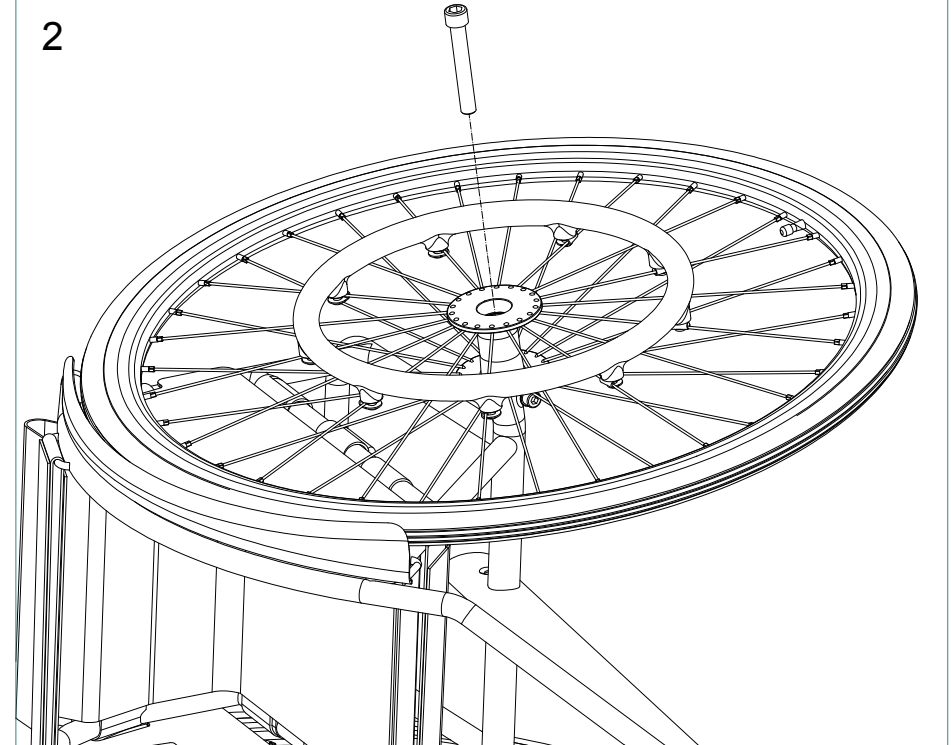

# Front Wheel Assembly

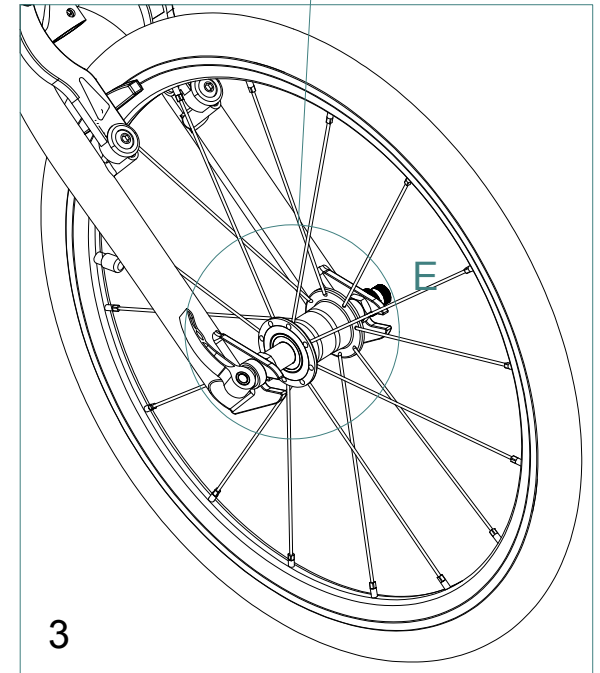
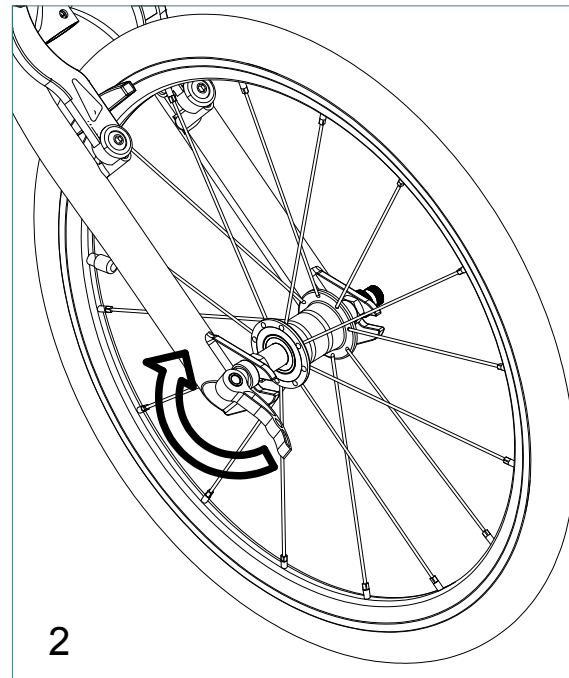
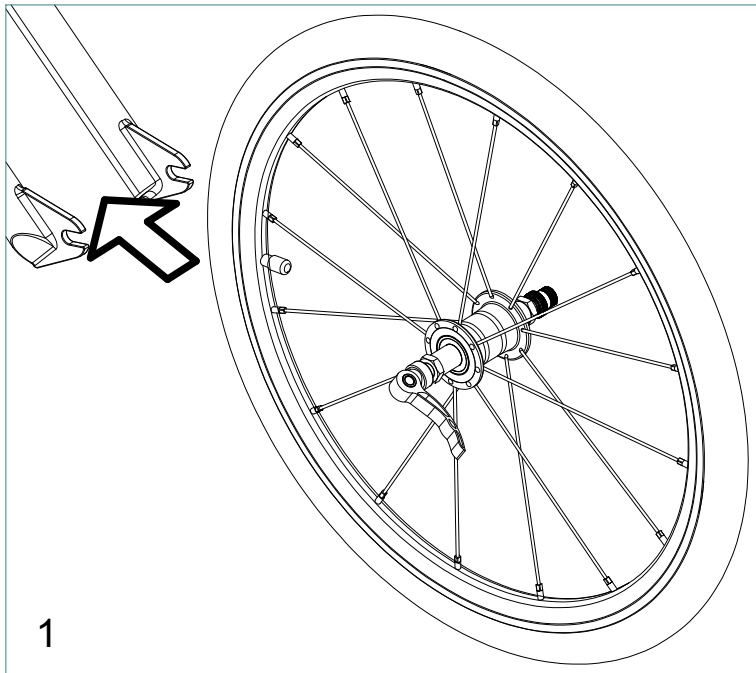
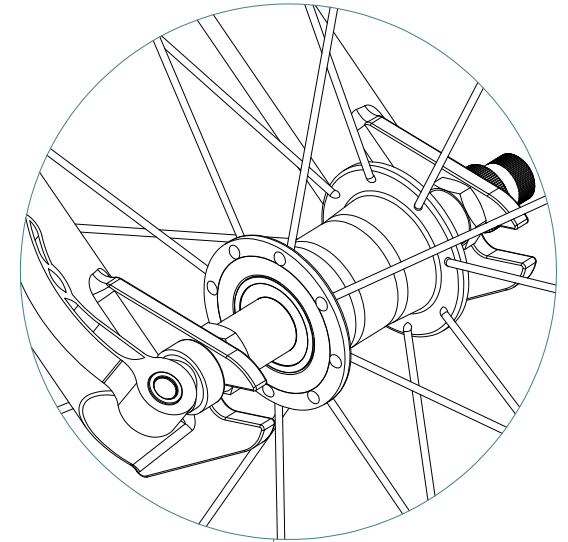
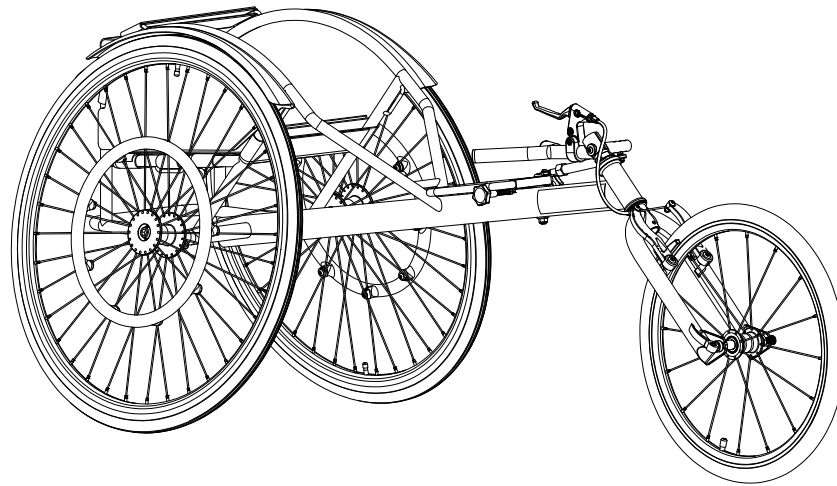

# Footplate Assembly and Adjustment

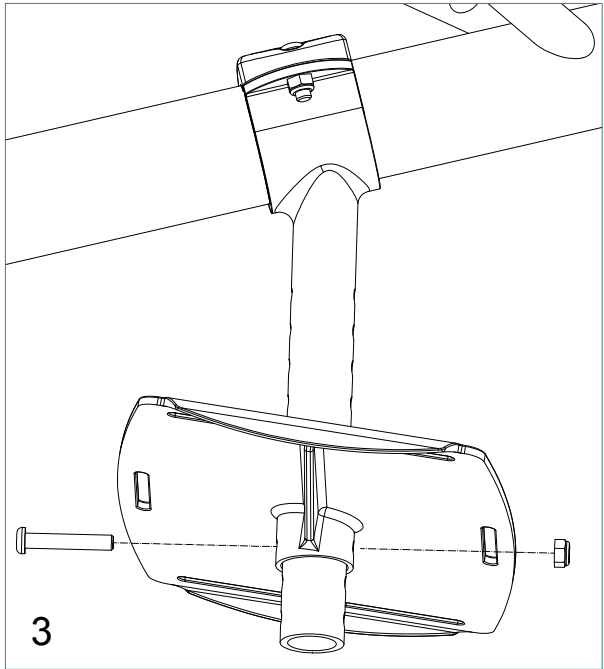
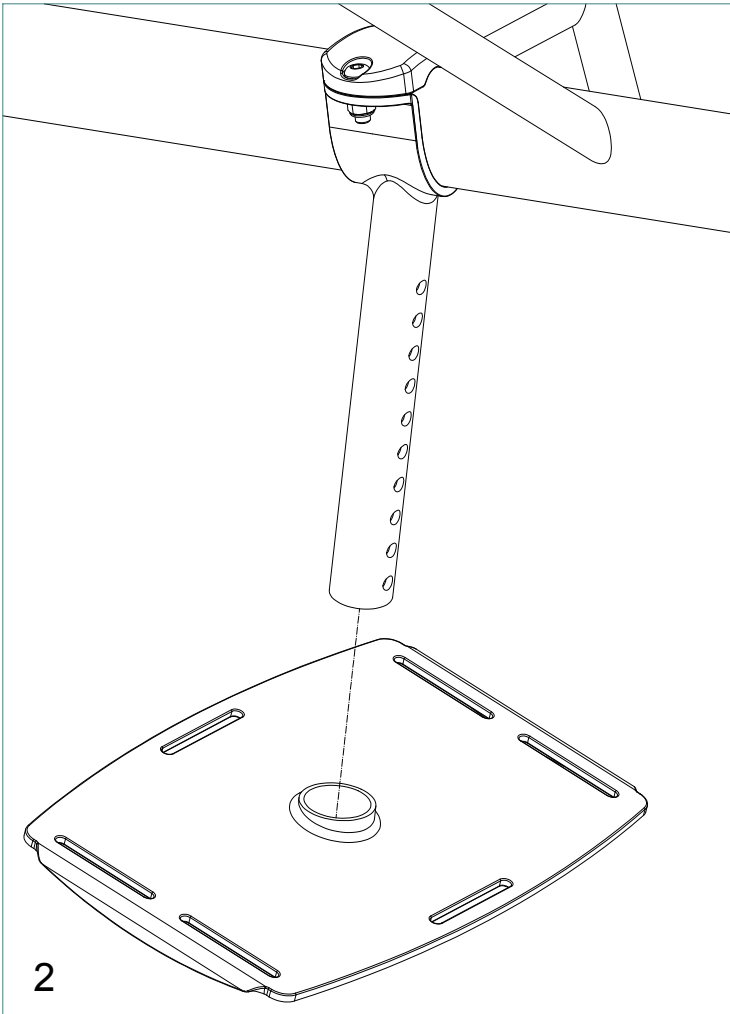
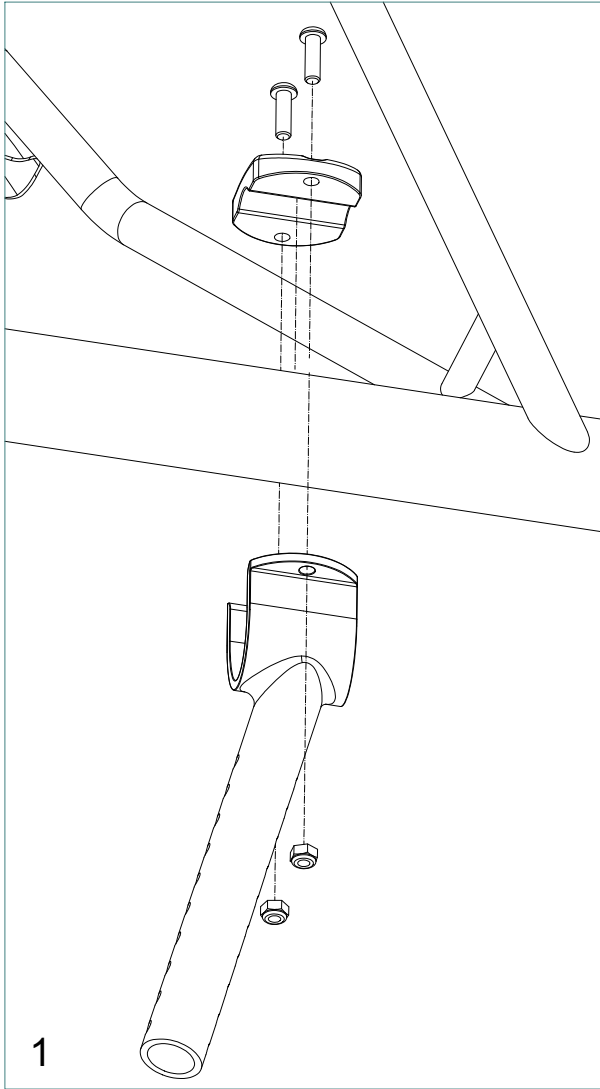
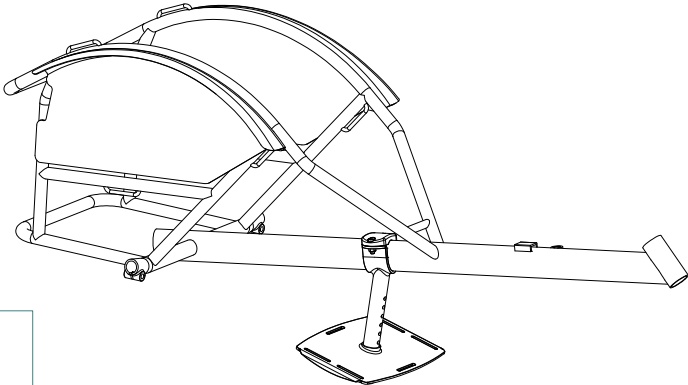
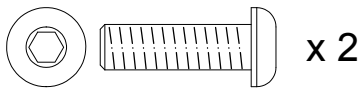
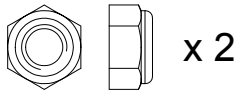

# Footplate Assembly and Adjustment

Footplate Height Adjustment Options

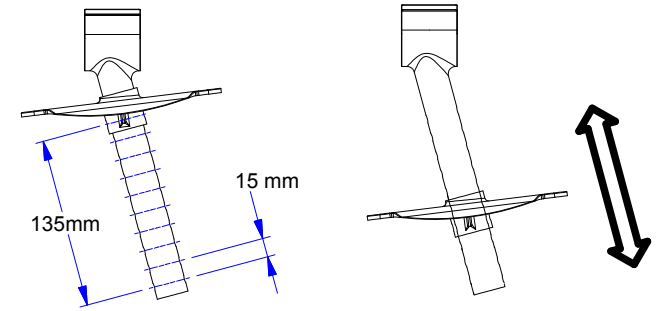

Footplate Angle options: A, B, C and D (all with forward/back adjustment, as shown)

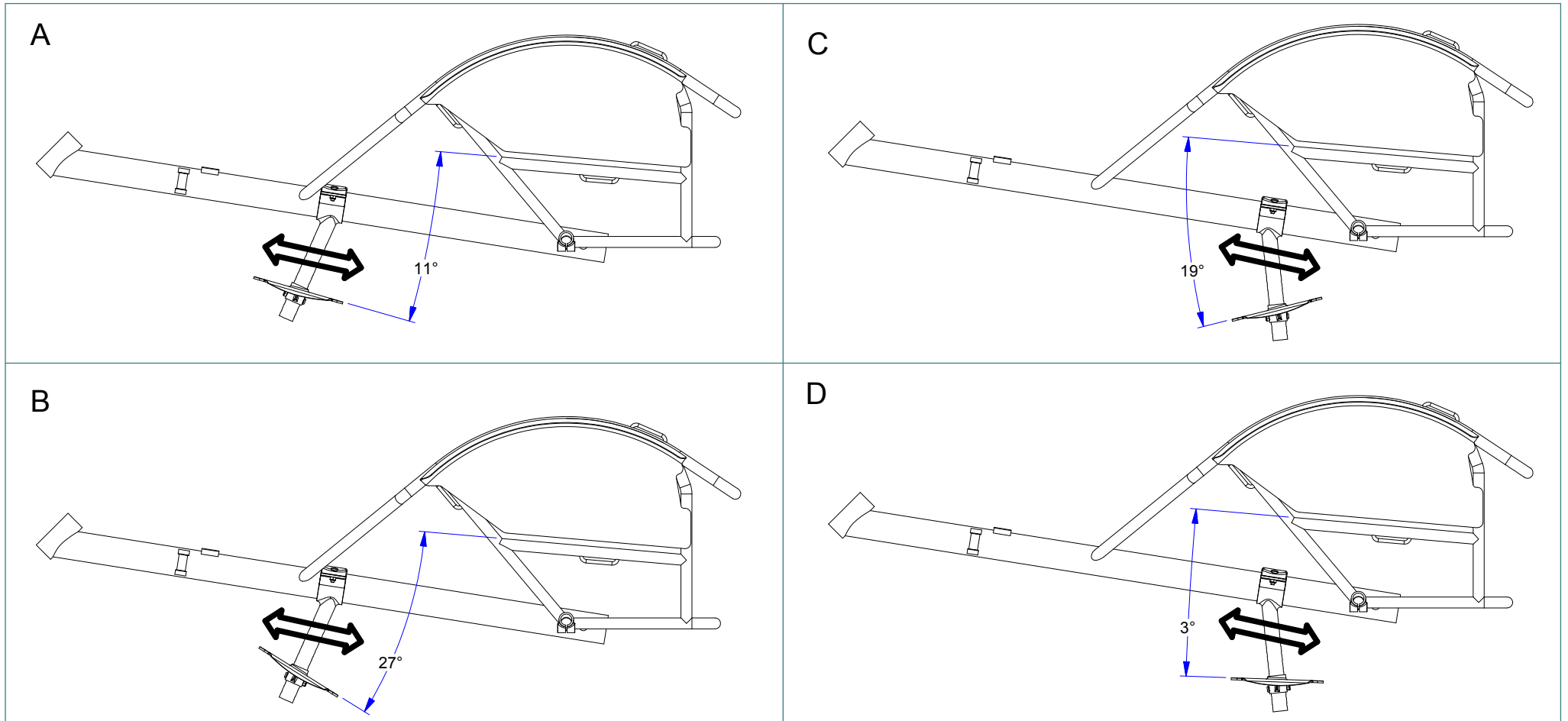

# Steering System Alignment

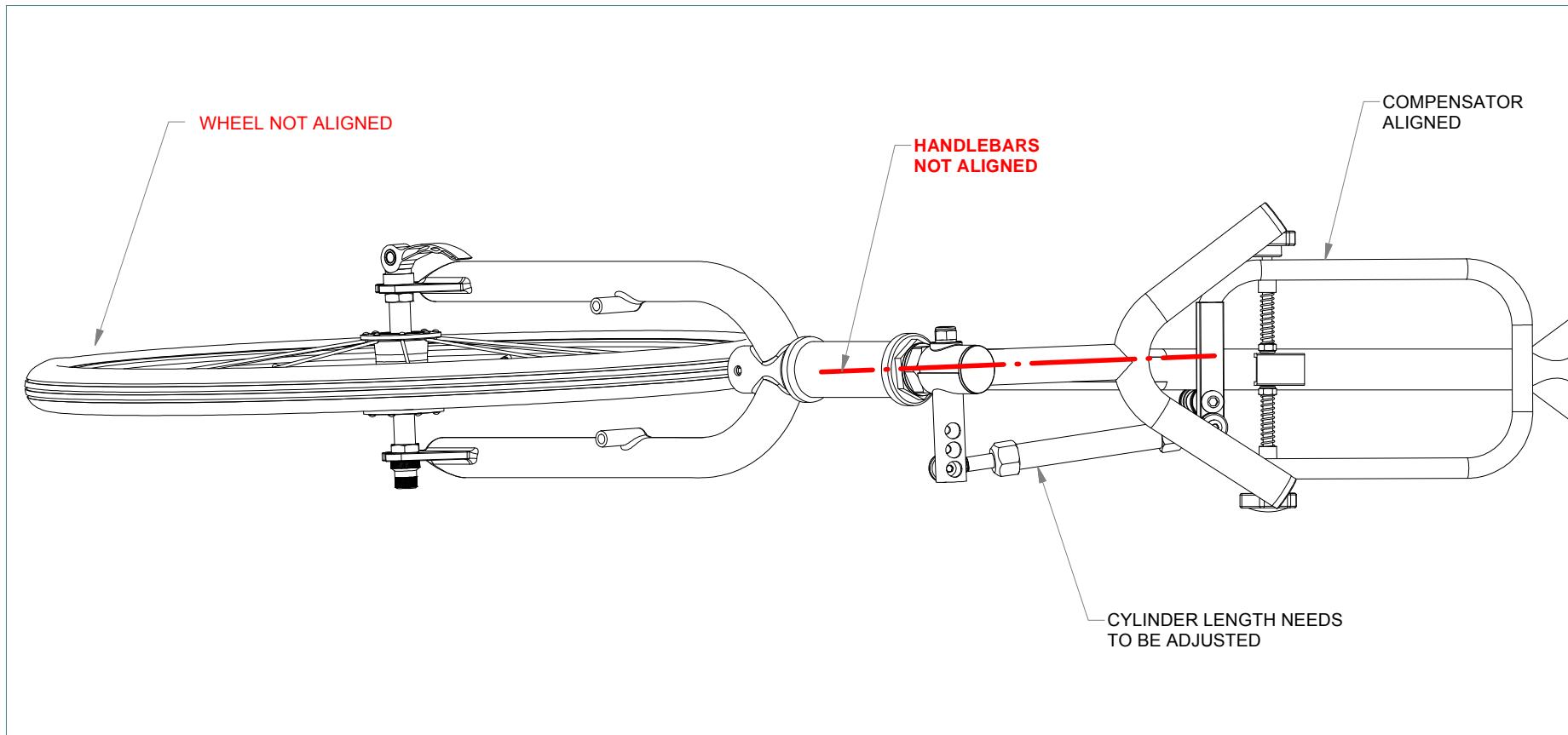

# Steering System Alignment

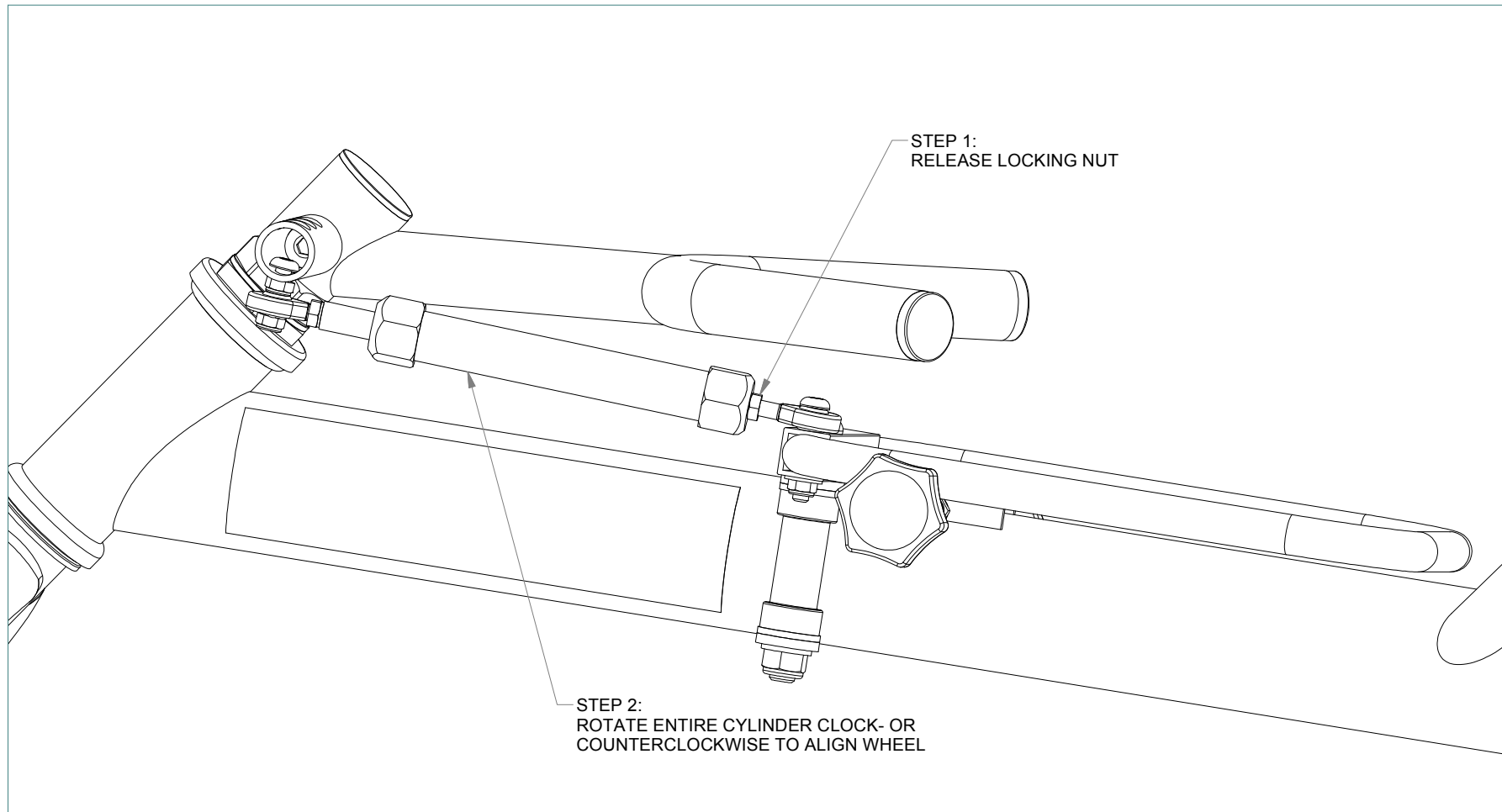

# Steering System Alignment

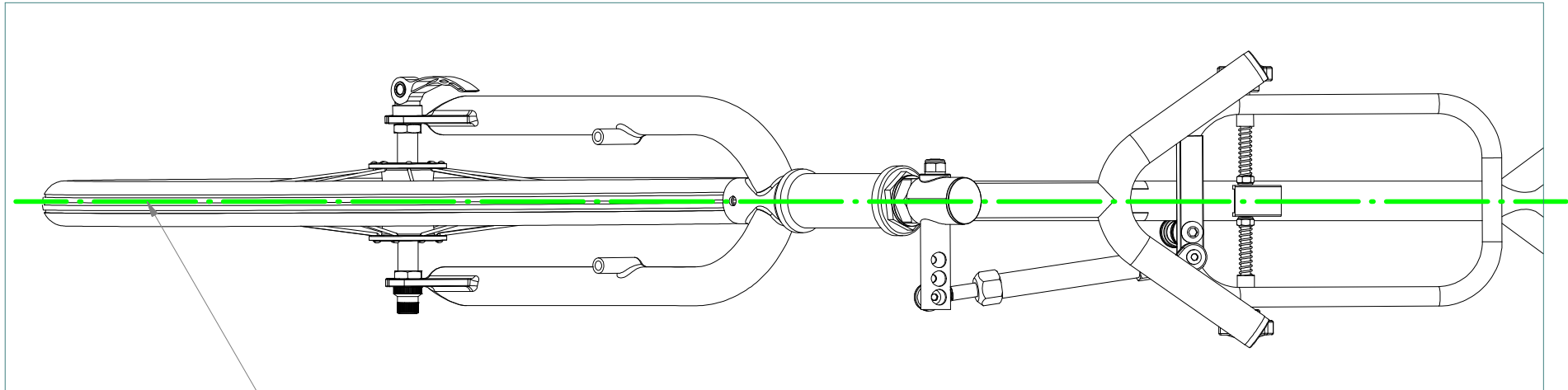

STEP 3: WHEN THE WHEEL IS PERFECTLY STRAIGHT,

LOCK THE CYLINDER BY TIGHTENING THE LOCKNUT

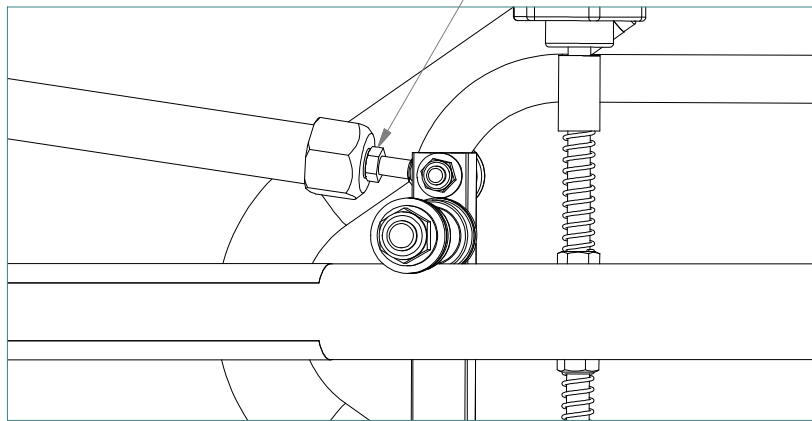



# Steering Adjustment

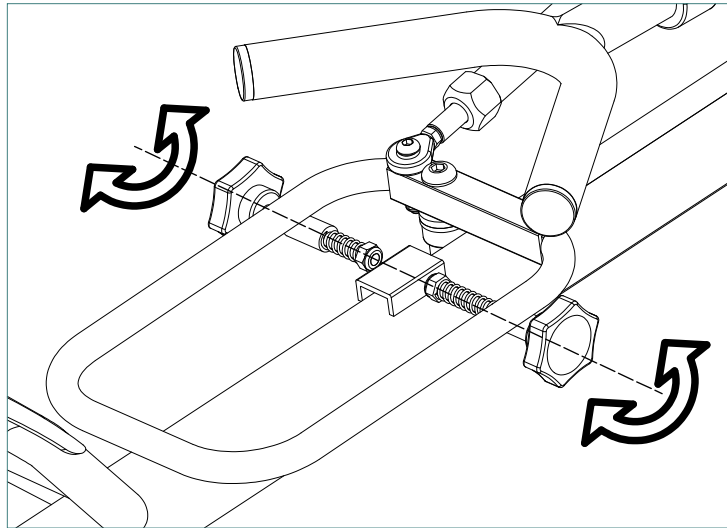
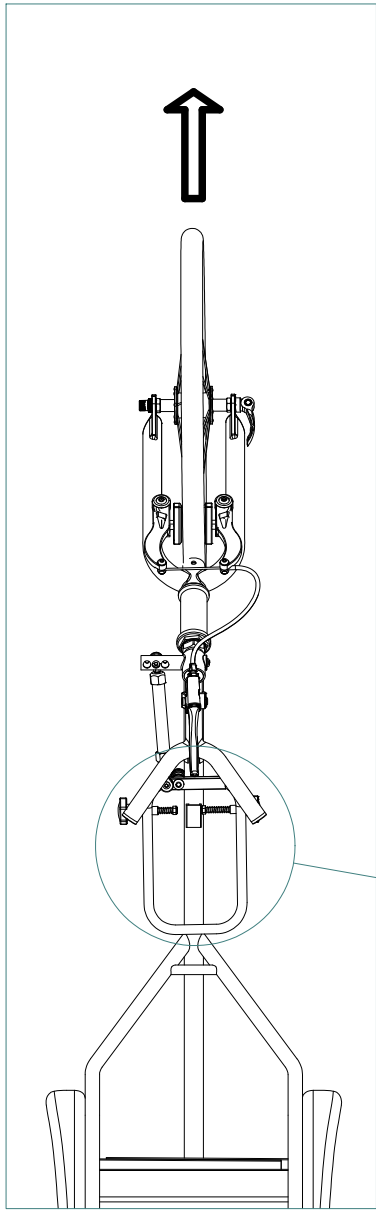

Rotate the 'compensator' bolts (above) to adjust for straight-line travel (as shown below, left) and to adjust for curved travel on a race track bend (as shown below, right)

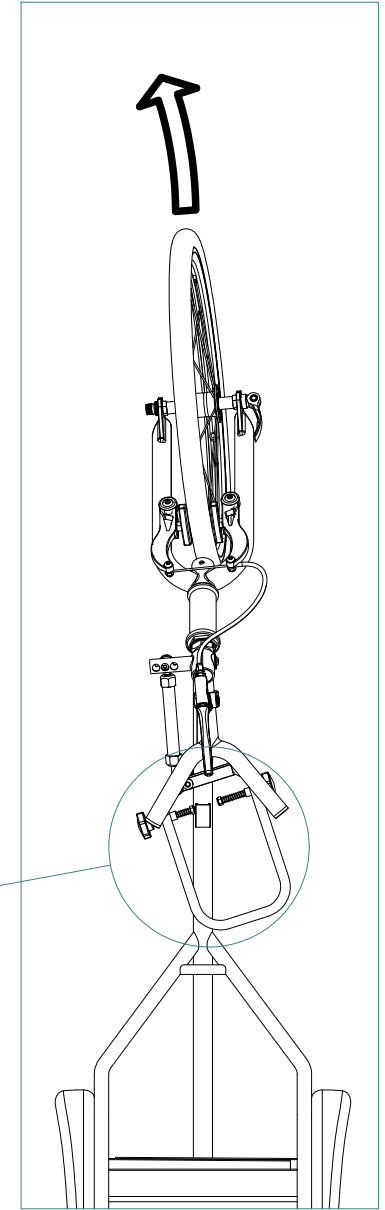
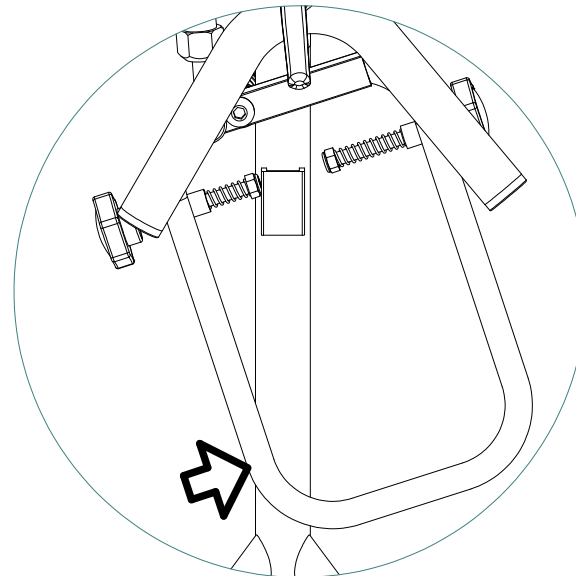
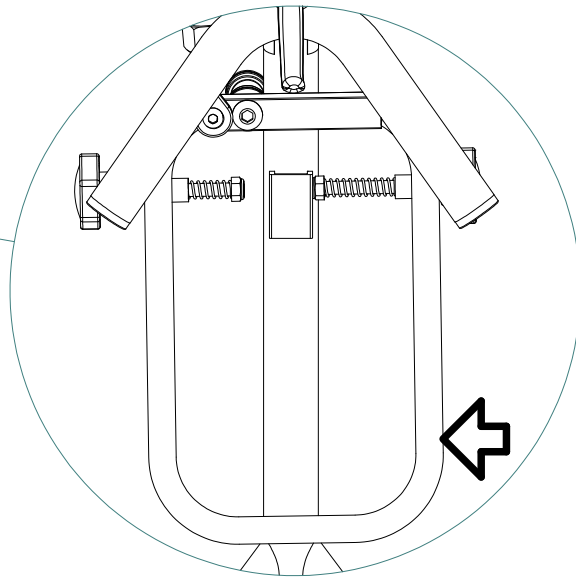

# Anti-Tip Bar Assembly and Adjustment

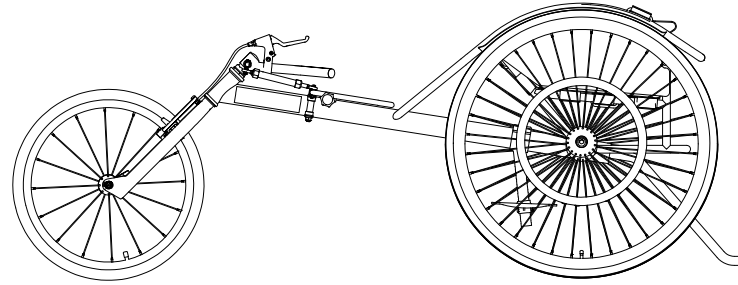
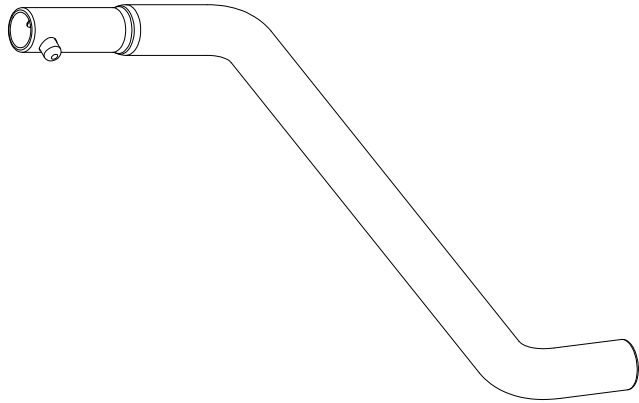

Anti-Tip Bar in correct downward position to stop the wheelchair tipping back

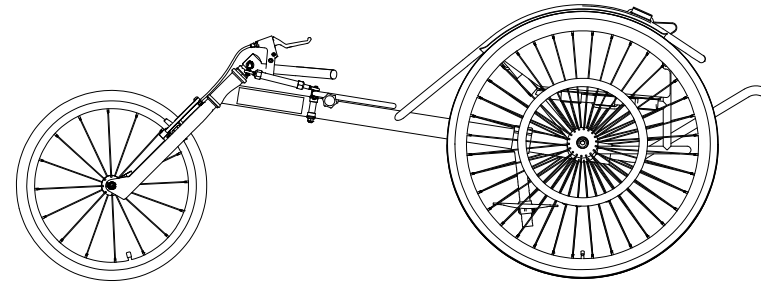

Anti-Tip Bar in upward position, for storing the Bar when not in use

Attaching the Anti-Tip Bar in place, using the spring-pin

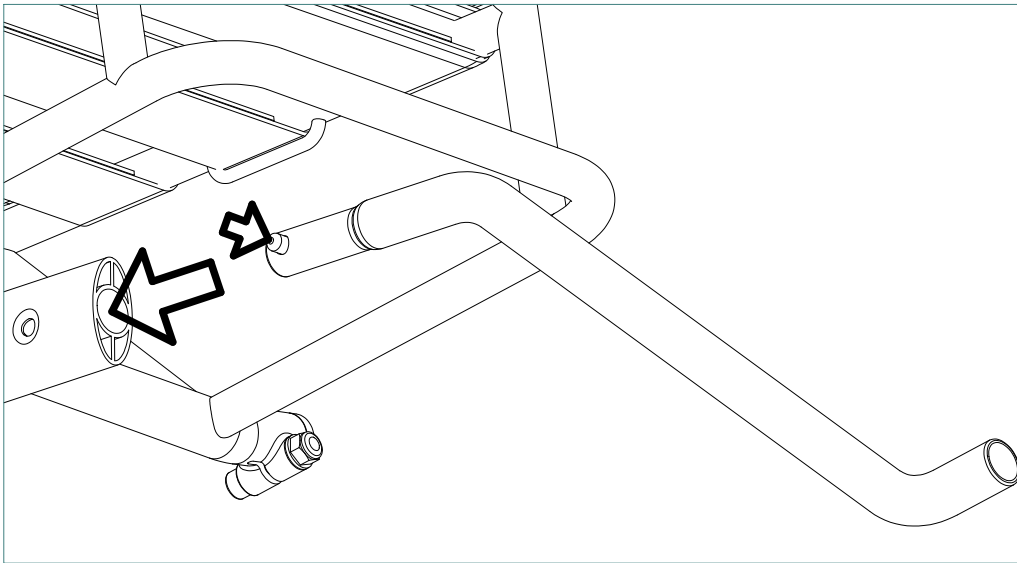

Removing the Anti-Tip Bar, using the spring-pin

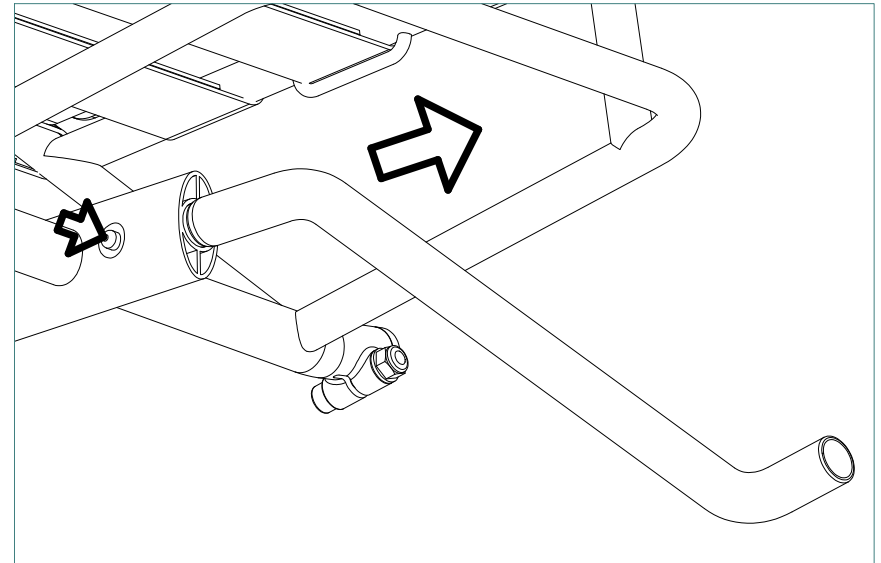

# Upholstery Assembly and Adjustment - 2 Positions

## Sitting Position

Backrest Panel set-up



View of backrest straps attached to seat rail



Backrest and Kneeling panel in place



## Kneeling Position

Backrest Panel set-up



Kneeling Panel set-up  
(angle of pad is altered by adjusting the straps)



Backrest and Kneeling panel in place

